

B-3CM

Flush-mounted magnetic contact

b3CM_en 09/25

The B-3CM magnetic contact is used to detect the opening of doors, windows, etc. It is designed for flush mounting.

1. Description

The B-3CM magnetic contact consists of a reed switch and a magnet (Fig. 1). Moving the magnet away from the reed switch (by opening the door or window) opens the reed switch contacts.

The reed switch and the magnet are placed in hermetic, gold-colored metal enclosures. The reed switch has wires run directly from its enclosure.

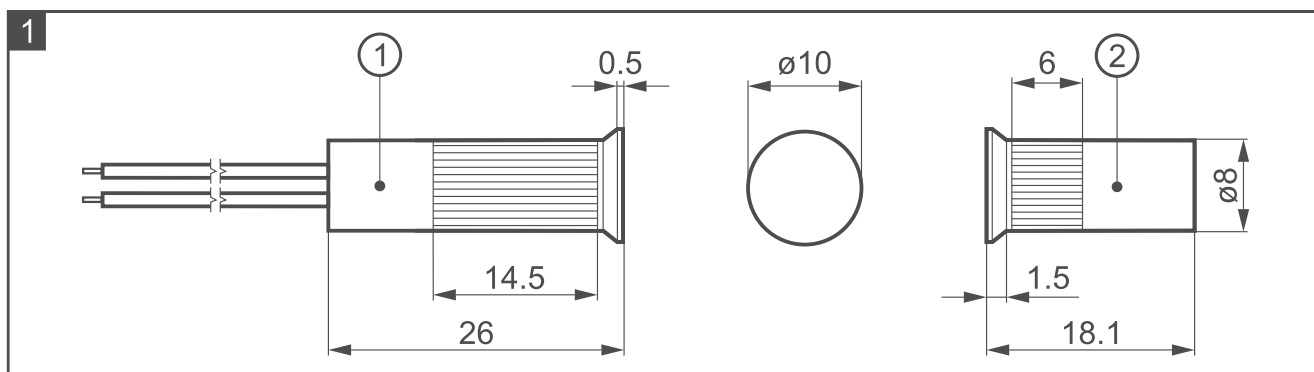

① reed switch

② magnet

2. Tips for installation



Disconnect power before making any electrical connections.

- The magnetic contact should be installed indoors, in spaces with normal air humidity.
- Install the reed switch in the window frame / door frame (fixed surface).
- Install the magnet in the window / door (moving surface).
- Do not install the magnetic contact in ferromagnetic materials or in the vicinity of strong magnetic or electric fields.
- The object in which the reed switch or magnet are to be installed should be at least 15 mm thick for the reed switch and at least 6 mm for the magnet to ensure adequate stability of the installed components.



Do not hammer the reed switch into the hole (you may break the reed switch).

3. Specifications

Magnetic contact type NC

Maximum switching voltage 100 V

| | |
|--|---------------|
| Maximum switching current..... | 0.5 A |
| Maximum contact rating | 10 W |
| Maximum contact resistance..... | 0.2 Ω |
| Make distance | 19 mm |
| Break distance | 24 mm |
| Operating temperature range..... | -10°C...+55°C |
| Maximum humidity | 93±3% |
| Environmental class according to EN50130-5 | II |
| Reed switch enclosure dimensions | 26 x 10 mm |
| Magnet enclosure dimensions | 18.1 x 10 mm |
| Length of wires..... | 450 mm |
| Weight..... | 16 g |

The declaration of conformity may be consulted at www.satel.pl/ce