



Addressable manual call point

ROP-400/EU

Firmware version 1.00

EN

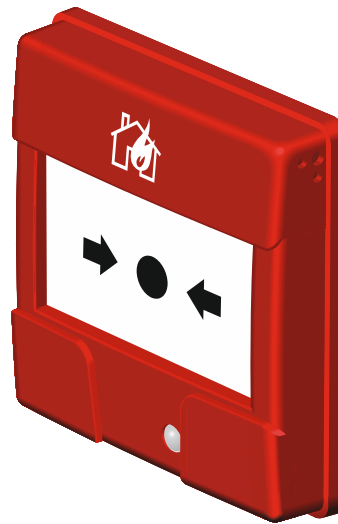

rop-400_en 02/23

Satel®

SATEL sp. z o.o. • ul. Budowlanych 66 • 80-298 Gdańsk • POLAND
tel. +48 58 320 94 00
www.satel.pl

IMPORTANT

The device should be installed by qualified personnel.

Prior to installation, please read carefully this manual in order to avoid mistakes that can lead to malfunction or even damage to the equipment.

Disconnect power before making any electrical connections.

Changes, modifications or repairs not authorized by the manufacturer shall void your rights under the warranty.

The following symbols may be used in this manual:



- note,



- caution.

This manual applies to the ROP-400/EU addressable manual call point for indoor use.

The ROP-400 call point is used to manually trigger an alarm when a fire is discovered. It is designed to operate in the detection line of the ACSP-402 addressable fire alarm control panel.

1. Features

- Resettable plastic pane.
- Key to enable:
 - testing,
 - resetting.
- LED indicator.
- Double-sided short-circuit isolator.
- Power supply from the detection line.
- Optional mounting box – ROP-BT / ROP-BS by SATEL.
- Optional protective cover to prevent unintentional activation – ROP-FLAP.

2. Description

Call point activation

Press hard on the pane to activate the manual call point. The pane will bend and the switch will open. When the pane is bent, the yellow strip is visible. When the call point is activated, the LED will start flashing red.



If the ROP-FLAP is installed on the call point, lift the flap before you press on the pane.

Call point reset

Use the key to reset the call point. Insert the key into the hole on the bottom of the call point, then pull it out to bring the pane back to its correct position (Fig. 1).

Call point test

1. Run the test function in the fire alarm control panel (see the ACSP-402 control panel manual). The LED on the call point will start flashing yellow.
2. Insert the key into the hole on the bottom of the call point. The pane will bend and the switch will open. The LED will start flashing alternately red and yellow (the signaling lasts 60 seconds).
3. Pull out the key to reset the call point.

LED indicator

The LED indicates:

- call point activation – flashing red,
- faulty call point – flashing yellow,
- test mode – flashing yellow,
- call point activation in test mode – flashing alternately red and yellow.

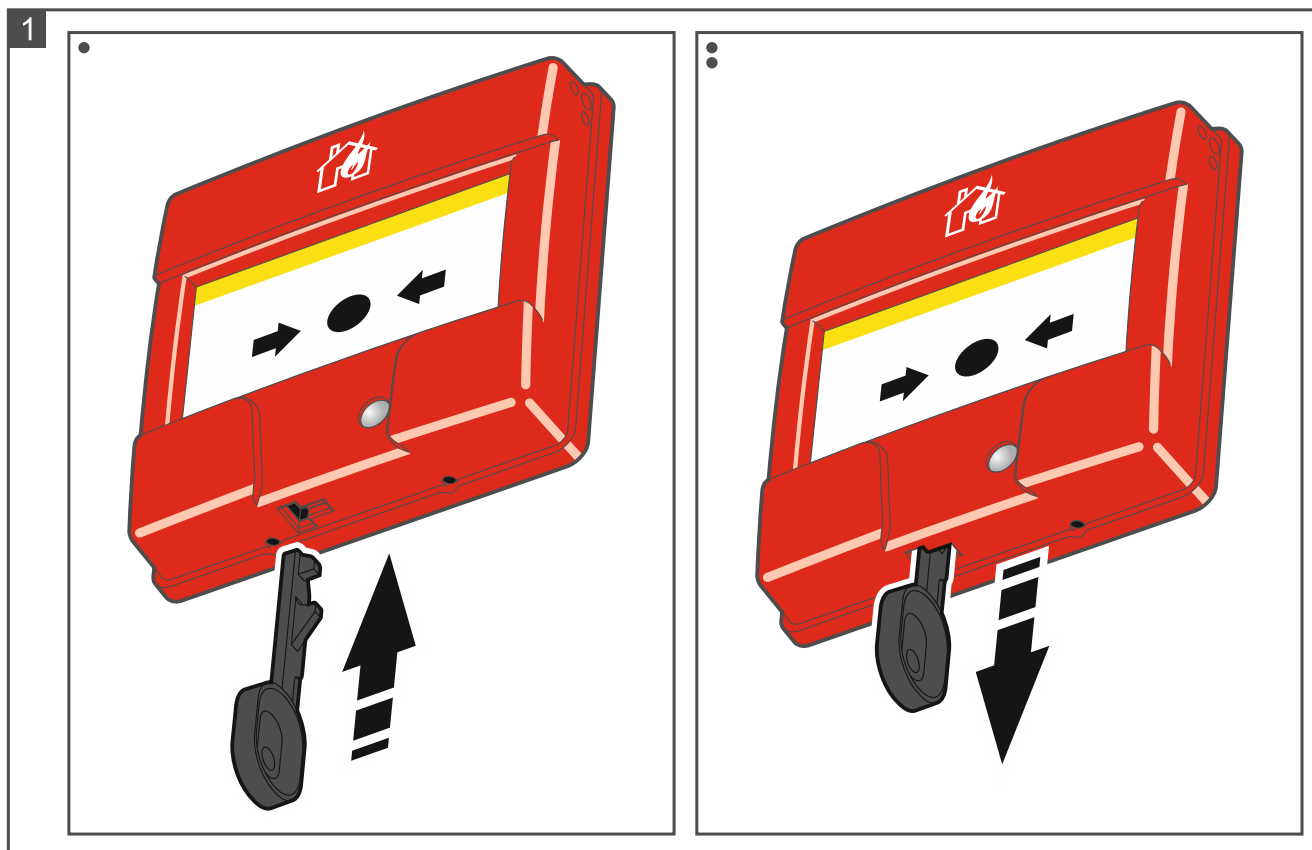

3. Installation



Disconnect power before making any electrical connections.

The ROP-400 manual call point is designed for installation indoors, in spaces with normal air humidity. Select the place of installation so that the call point is visible and easily accessible.

The instructions below describe how to install the call point using the ROP-BT / ROP-BS mounting box by SATEL. The mounting box is sold separately. Instead the SATEL surface mounting box, you can use a flush-mounted box (Fig. 12).

1. Place the mounting box against the wall and mark the location of the mounting holes (Fig. 2).
2. Drill the holes for wall plugs (anchors).
3. Run the cables through the hole in the box (Fig. 2).
4. Use wall plugs (anchors) and screws to secure the mounting box to the wall. Select wall plugs specifically intended for the mounting surface (different for concrete or brick wall, different for plaster wall, etc.).
5. Remove the call point cover (Fig. 3).
6. Connect the detection line wires to the call point (Fig. 4 – loop; Fig. 5 – radial circuit). To terminals A+ and A-, connect the wires from the control panel / previous device. Connect the wires to terminals B+ and B- to connect the call point to the next device / control panel. For radial circuits, if the call point is the last device in the circuit, do not connect the wires to terminals B+ and B- (Fig. 5). Connect the cable shields to the E / \perp terminals.
7. Use screws to secure the call point to the mounting box (Fig. 6-7).
8. Insert the pane (Fig. 8-9).
9. Replace the enclosure cover (Fig. 10-11).

10. Insert the key into the hole on the bottom of the call point, then pull it out to set the pane in its correct position.

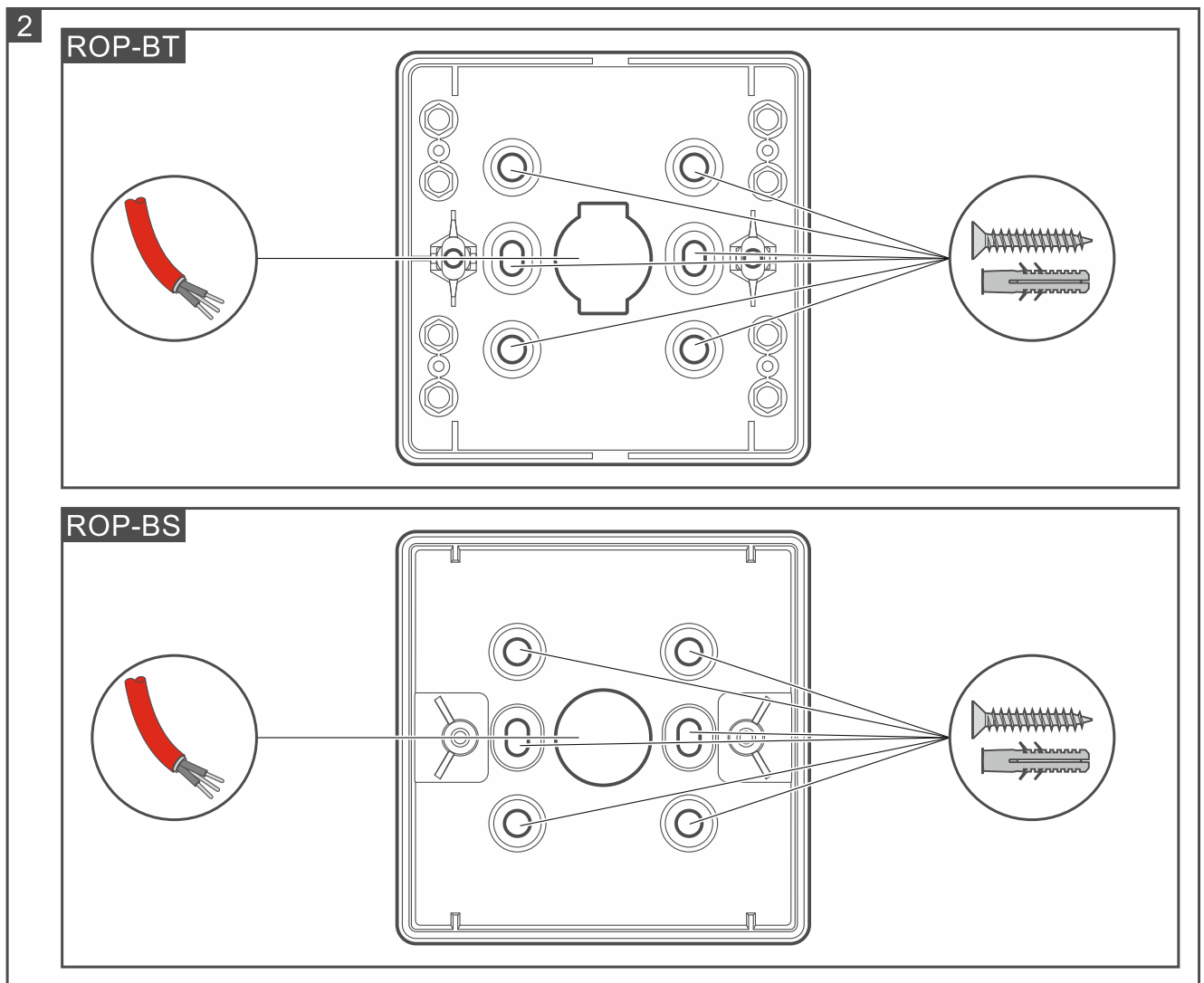

3

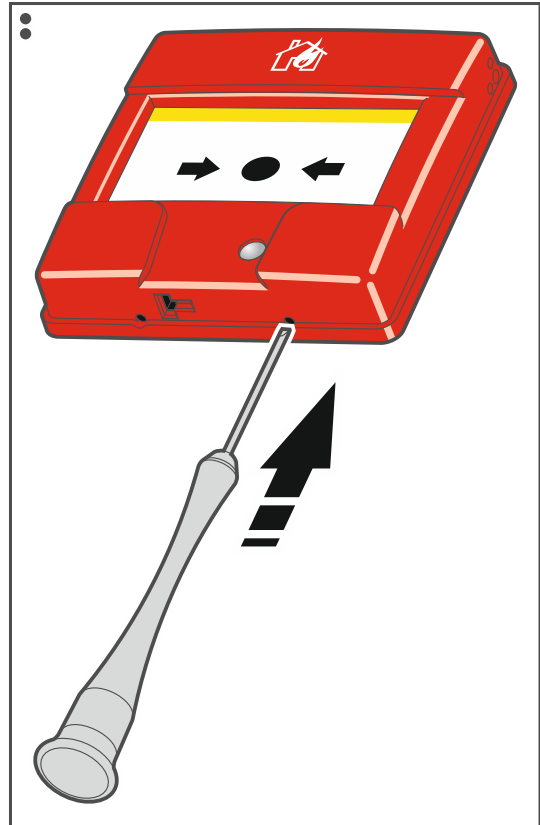
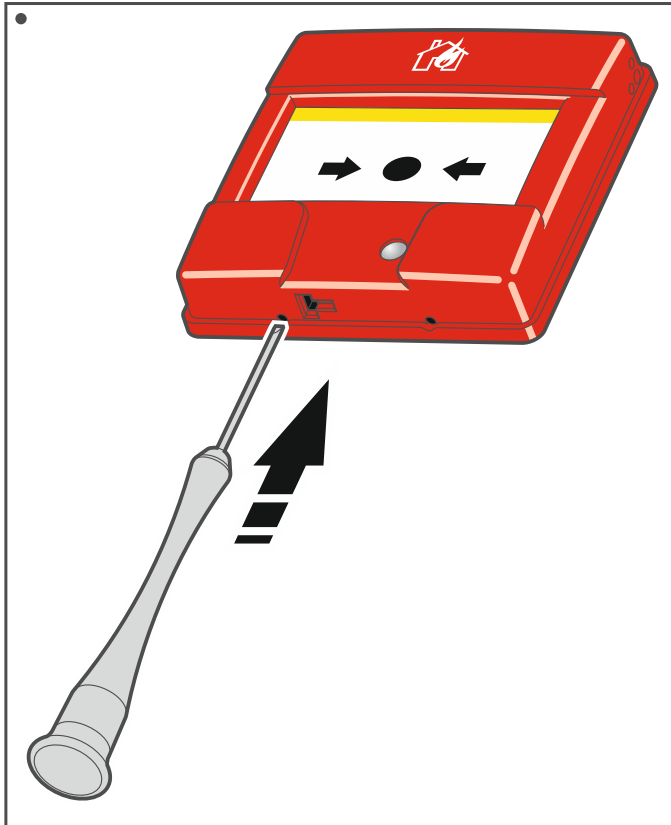

4

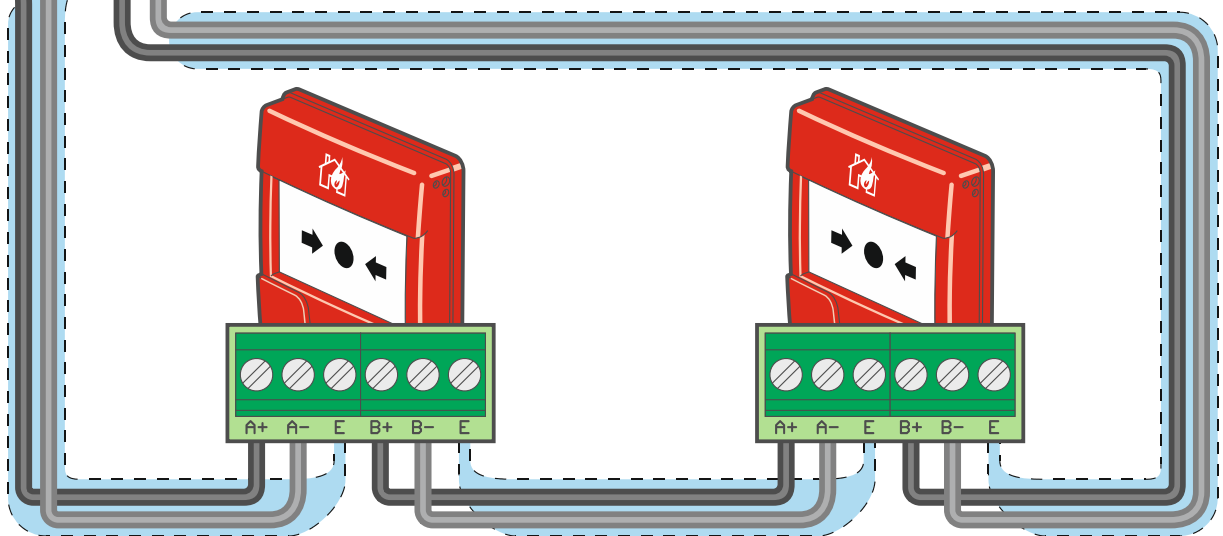
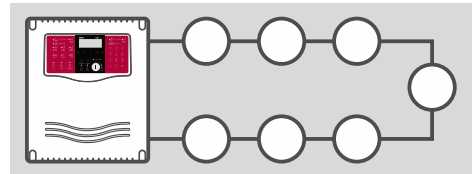
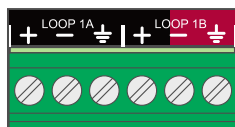

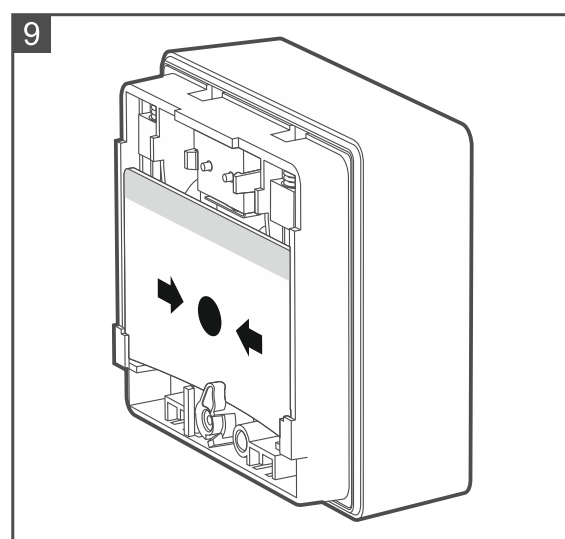
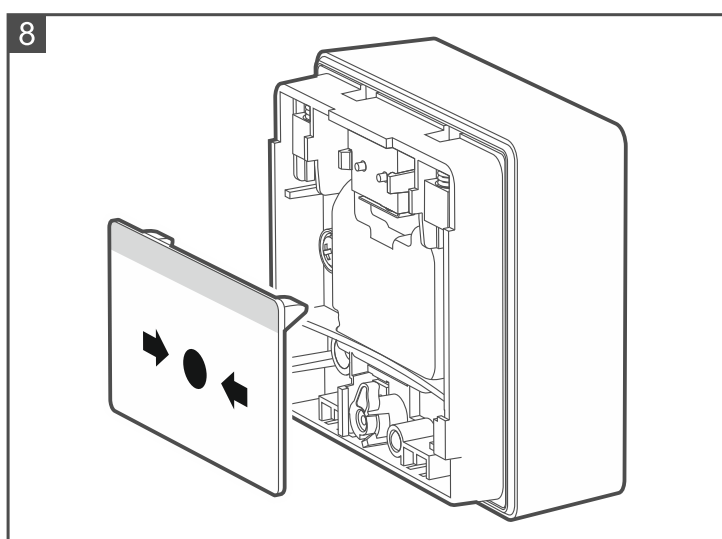
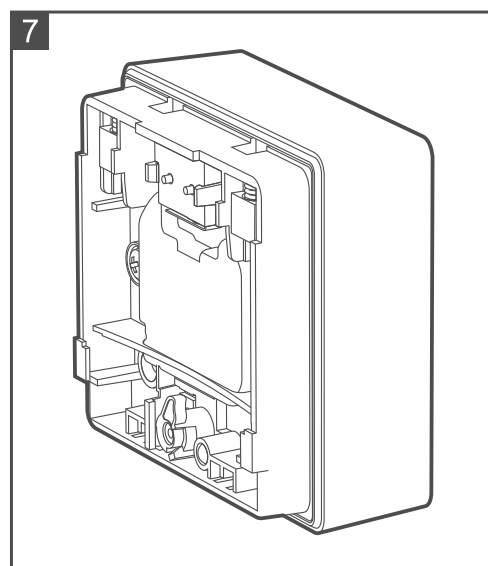
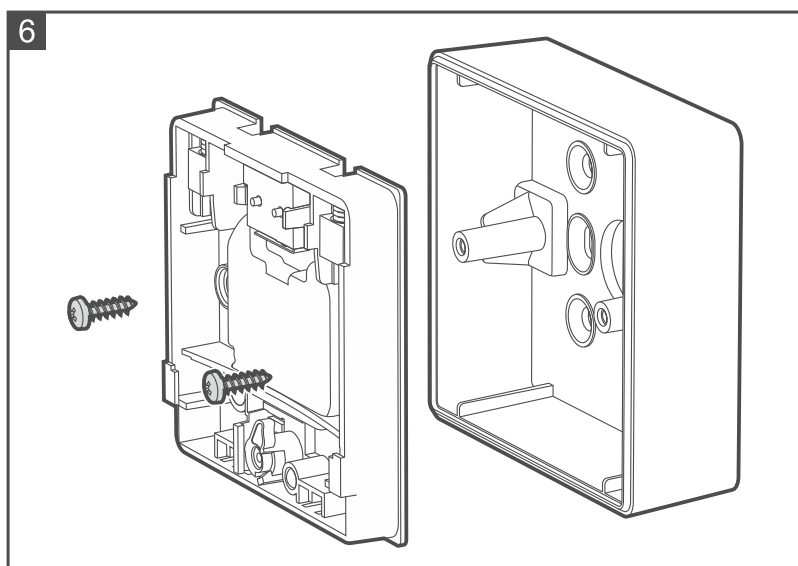
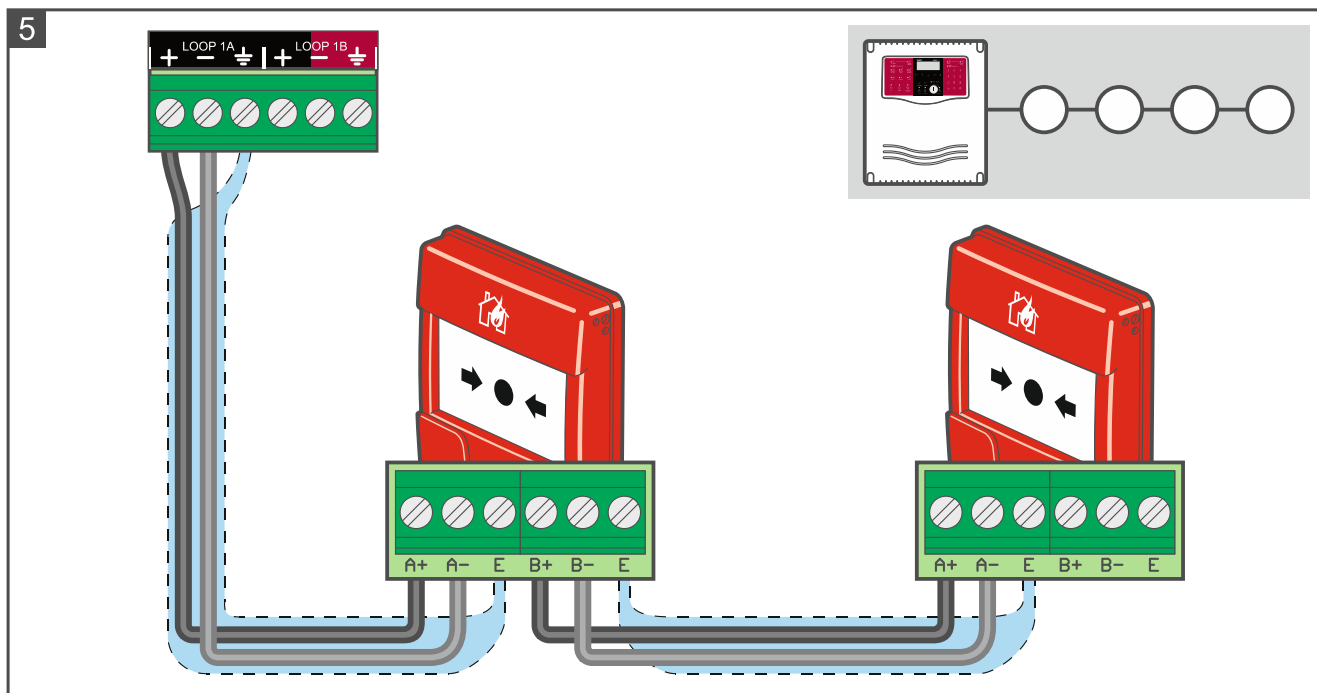

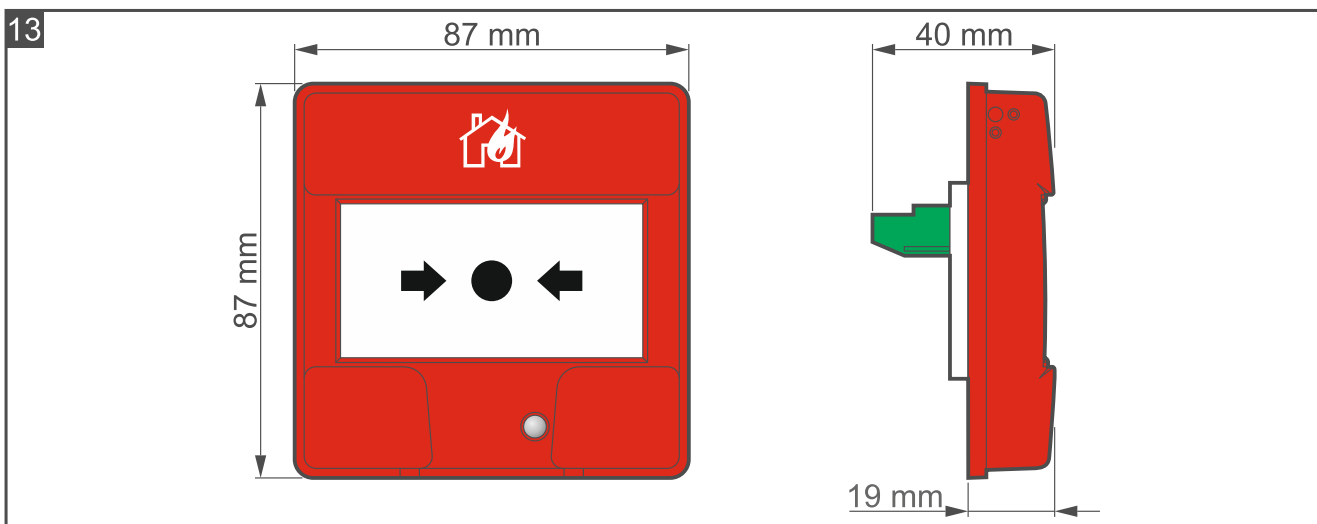
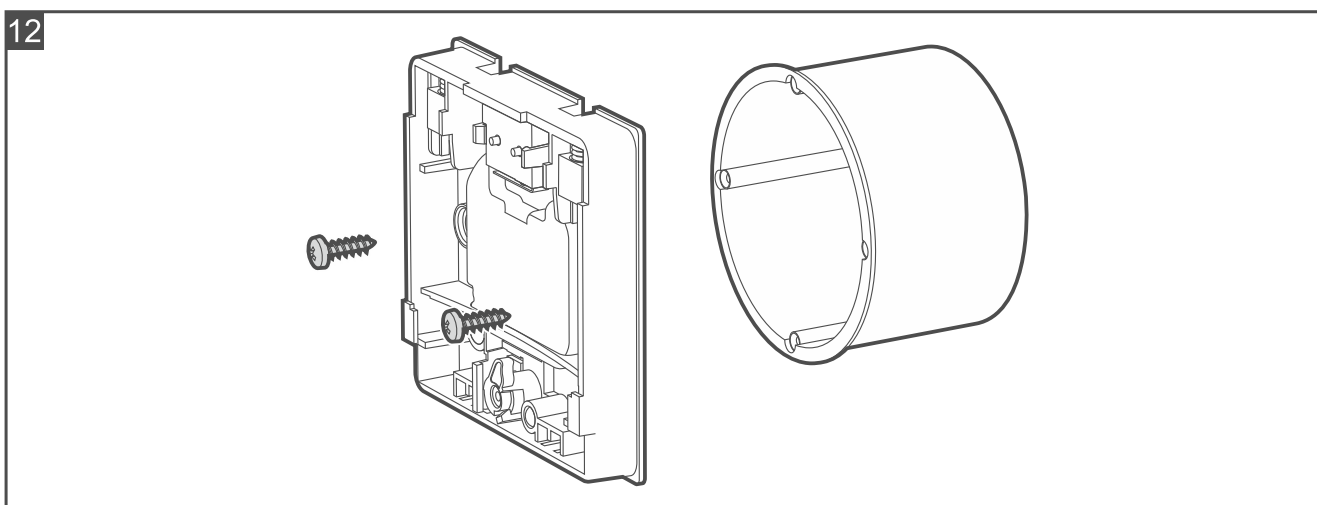
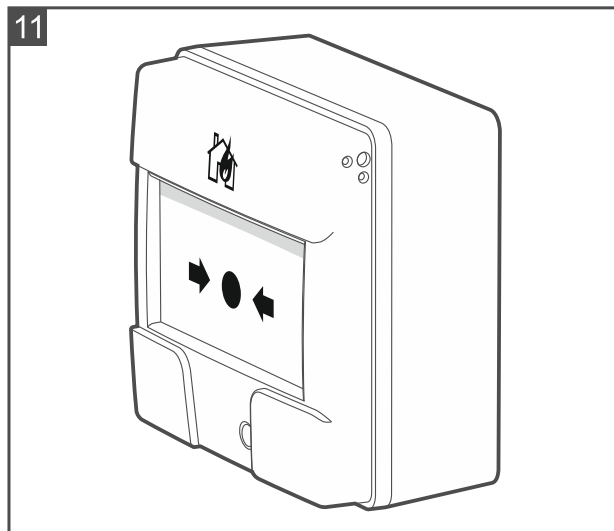
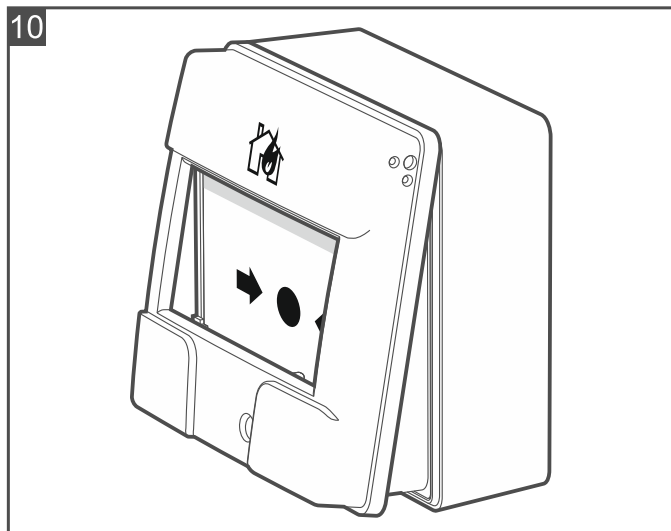

4. ROP-FLAP

You can install the ROP-FLAP on the call point (Fig. 14). It is a transparent protective cover that prevents unintentional activation of the call point. The flap is sold separately.

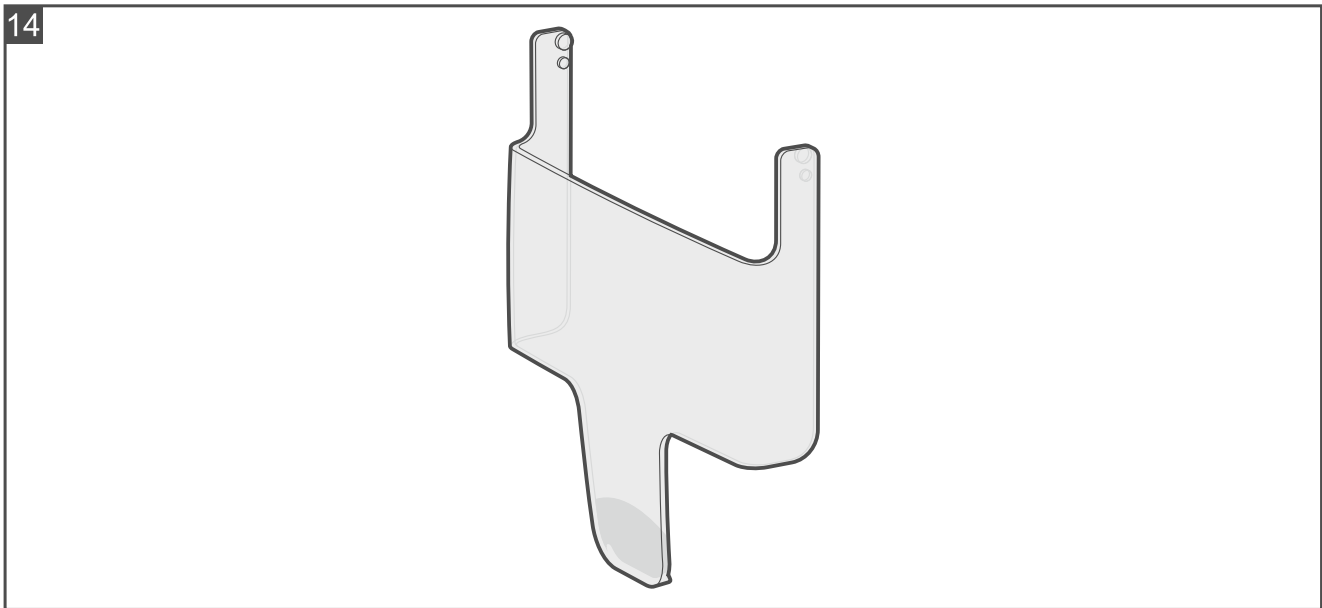

5. Maintenance

The fire alarm system elements require regular maintenance. The periodic checks of the ROP-400 manual call point should be carried out at least every 6 months. In spaces where working conditions are difficult (e.g. dust, aggressive environment that may cause corrosion, etc.), the periodic checks should be carried out more often.

As part of maintenance, start a test in the control panel and activate the manual call point. Please go to the ACSP-402 control panel manuals to find out how to start the test. Start of the test and test activation of devices will be registered in the control panel event log. During the test, make sure the device is in its right place (e.g. it has not been swapped with another device). To activate the manual call point, insert the key into the hole on the bottom of the call point (Fig. 1).

6. Specifications

ROP-400

Supply voltage	18...26 VDC
Quiescent current consumption	0.17 mA
Alarm current consumption	0.45 mA
Operating temperature range.....	-10°C...+55°C
Maximum humidity	95%
Dimensions	87 x 87 x 40 mm
Weight.....	86 g

ROP-BS

Dimensions	87 x 87 x 28 mm
Weight.....	57 g

The ROP-400/EU manual call point conforms to the essential requirements of the EU Regulations and Directives:

CPR 305/2011 Regulation of the European Parliament and of the Council of 9 March 2011 laying down harmonized conditions for the marketing of construction products and repealing the Council Directive 89/106/EEC on construction products;

EMC 2014/30/UE Electromagnetic Compatibility Directive;

LVD 2014/35/EU Low Voltage Directive.

The CNBOP-PIB Certification Body in Józefów issued the Certificate of Constancy of Performance **1438 CPR-0887** for the construction product ROP-400/EU manual call point, confirming its compliance with the requirements of EN 54 11:2001+A1:2005, EN 54-17:2005 + AC:2007.

The Certificate and the Declaration of Performance can be downloaded from the **www.satel.pl** website.

The ROP-400/EU manual call point has been granted the Certificate of Admittance **No 4848/2023** by the CNBOP-PIB in Józefów.

The Certificate of Admittance can be downloaded from the **www.satel.pl** website.



SATEL Sp. z o.o. • ul. Budowlanych 66 • 80-298 Gdańsk • POLAND

1438

1438-CPR-0887

Declaration of Performance DOP/CPR/0887

EN 54 11:2001+A1:2005

EN 54-17:2005 + AC:2007

Fire safety. Manual fire alarm reporting.

Type A manual call points.

Use – see the Declaration of Performance DOP/CPR/0887.

Technical specifications – see this manual.